

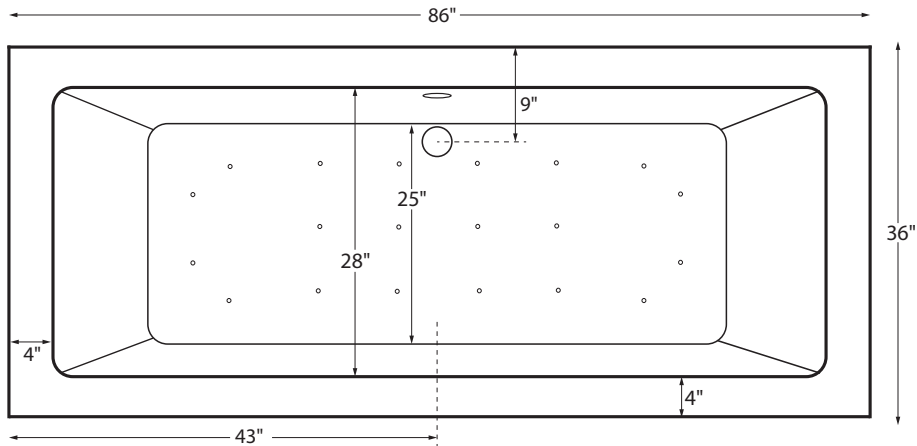

Available as a freestanding model or finished on 1, 2 or 3 sides for various installation applications.

Andrea® 27
with Sculpted Finish®

MODEL 229A	
86" x 36" x 23"	
FREESTANDING or ALCOVE 109 gal to overflow	
Acrylic CXL®	DoloMatte®
140 lbs / 64 kg	<SOAKER> 158 lbs / 72 kg
Filling this tub to the maximum may require an above average size or dedicated water heater.	



The Sculpted Finish process does not allow enough space for mounting fixtures on the tub deck.
Shown as Air Bath

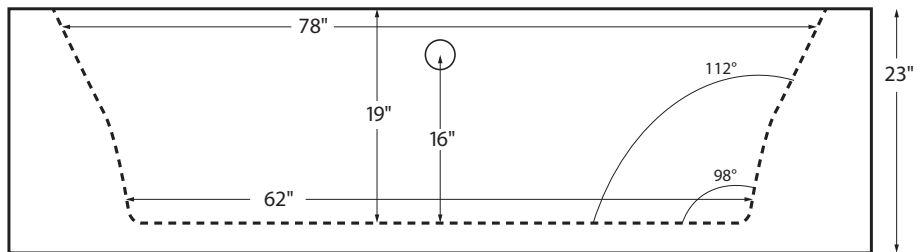

ELECTRICAL COMPONENTS & SPECIFICATIONS		
Hydrotherapy Package	Components Included	GFCI/110V
Microbubbles	Microbubbles pump	1-15 amp
Air Massage	heated blower	1-15 amp
Microbubbles with Air	Microbubbles pump, heated blower	1-20 amp
Air Massage Elite	heated blower, chromatherapy	1-15 amp
Microbubbles with Air Elite	Microbubbles pump, heated blower, chromatherapy	2-15 amp

Electrical requirements may change with the addition of optional therapy components. See specific option details or installation information, CSA Certified C/US; B45.5/IAPMO ANSI Z124.1 and ANSI 112.19.7

IMPORTANT ORDERING & INSTALLATION INFORMATION

- Before ordering or installing, please consider future access to equipment.
- Unless ordering Sculpted Finish on 4 sides, please include a diagram specifying which sides will need to be finished, along with location of optional tile flange(s).
- Overflow is factory installed for provided toe tap drain.
- When ordering an air bath, the air blower must be remote mounted.
- Microbubbles system components must be installed on a non-Sculpted Finish side. Components will extend beyond the perimeter of the tub. Call MTI for specific details regarding the desired installation before placing the order.
- Radiance placed on floor locations will affect placement of air jets.
- Hydrotherapy equipment may ship loose for remote installation. See package content on the following page for details.
- Faucet valves cannot be installed on this tub model.
- All tubs are compliant with ASTM C 1028-07 coefficient of friction. DoloMatte meets ANSI A137.1/A326.3 coefficient of friction and AS HB198:2014 slip tests.

See the Installation & Operation Manual for more details.
MTI's Customer Service: Monday-Friday 8am-6pm EST
800-783-8827 or service@mtibaths.com

• Options and accessories may be packaged inside the tub crate. Always check packaging before discarding.
• All product measurements are ±1/2".
• Specifications and configurations are subject to change without notice.
• Measurements herein supersede all others published prior to publication date below.



Andrea 27
with Sculpted Finish®
MODEL 229A
86" x 36" x 23"

Hydrotherapy Packages	Package Contents	Sculpted Finish Sides	Acrylic CXL®		DoloMatte®	
			Part #	MSRP	Part #	MSRP
Soaker	Soaking bath - no jets, pre-leveled foam base, factory installed rectangular overflow with toe tap drain	4-sides sculpted	S229A4	\$9,465	S229D4	\$10,545
		3-sides sculpted	S229A3	\$8,820	S229D3	\$9,765
		2-sides sculpted	S229A2	\$7,285	S229D2	\$8,095
		1-side sculpted	S229A1	\$6,910	S229D1	\$7,585
Microbubbles	1 infusion port, microbubbles pump, pre-leveled foam base, factory installed rectangular overflow with toe tap drain	4-sides sculpted	n/a	n/a	n/a	n/a
		3-sides sculpted	M229A3	\$11,810	M229D3	\$12,755
		2-sides sculpted	M229A2	\$10,275	M229D2	\$11,085
		1-side sculpted	M229A1	\$9,900	M229D1	\$10,575
Air Massage	20 air jets, heated air blower, pre-leveled foam base, factory installed rectangular overflow with toe tap drain	4-sides sculpted	AST229A4	\$12,750	AST229D4	\$13,830
		3-sides sculpted	AST229A3	\$12,105	AST229D3	\$13,050
		2-sides sculpted	AST229A2	\$10,570	AST229D2	\$11,380
		1-side sculpted	AST229A1	\$10,195	AST229D1	\$10,870
Air Massage Elite	30 air jets, heated air blower, Chromatherapy LED lighting, Spa Mode, pre-leveled foam base, factory installed rectangular overflow with toe tap drain	4-sides sculpted	AE229A4	\$14,460	AE229D4	\$15,540
		3-sides sculpted	AE229A3	\$13,815	AE229D3	\$14,760
		2-sides sculpted	AE229A2	\$12,280	AE229D2	\$13,090
		1-side sculpted	AE229A1	\$11,905	AE229D1	\$12,580
Microbubbles with Air Massage	1 infusion port, microbubbles pump, 20 air jets, heated air blower, pre-leveled foam base, factory installed rectangular overflow with toe tap drain	4-sides sculpted	n/a	n/a	n/a	n/a
		3-sides sculpted	ASTM229A3	\$14,555	ASTM229D3	\$15,500
		2-sides sculpted	ASTM229A2	\$13,020	ASTM229D2	\$13,830
		1-side sculpted	ASTM229A1	\$12,645	ASTM229D1	\$13,320
Microbubbles with Air Massage Elite	1 infusion port, microbubbles pump, 30 air jets, heated air blower, Chromatherapy LED lighting, Spa Mode, pre-leveled foam base, factory installed rectangular overflow with toe tap drain	4-sides sculpted	n/a	n/a	n/a	n/a
		3-sides sculpted	AEM229A3	\$16,175	AEM229D3	\$17,120
		2-sides sculpted	AEM229A2	\$14,640	AEM229D2	\$15,450
		1-side sculpted	AEM229A1	\$14,265	AEM229D1	\$14,940

Microbubbles system components must be installed on a non-Sculpted Finish® side.

Components will extend beyond the perimeter of the tub. Call MTI for specific details regarding the desired installation before placing order.

For more customized applications, additional hydrotherapies may possibly be integrated in Sculpted Finish® tubs, depending on the types of therapy and the installation application. Visit mtibaths.com or call MTI at 800.783.8827.

RECOMMENDED SENSORY THERAPIES

Chromatherapy

(LE) **\$800** underwater lighting
2 LED lights included

Audiotherapy

(STEREOBT) **\$1,390** 2 transducers with bluetooth and amplifier
(BTREMOTE) **\$600** bluetooth remote

(STEREOH202) **\$1,575** 4 transducers
amplifier not included

Thermaltherapy

(RAD100) **\$1,595** Radiance®
2 heated zones included



For more information on options and accessories go to Acrylic Tub Options on mtibaths.com

Andrea 27 with Sculpted Finish®
MODEL 229A

Options <i>Must be ordered at time of purchase.</i>	
Standard Color White (CWH) gloss Acrylic CXL, matte DoloMatte	
Textured, Slip-Resistant Bottom (TXTBTM) \$105 DoloMatte® exceeds ANSI A137.1/A326.3 and AS HB198 slip tests.	
Ozonator (OZONE) \$515	
Installation Options <i>Must be ordered at time of purchase.</i>	
Tile Flange	
Factory Installed rigid ABS	
1 Side (TFK1) \$175	IMPORTANT: <i>Must specify flange location(s) on order of Factory-Installed Flange.</i>
2 Sides (TFK2) \$185	
3 Sides (TFK3) \$200	
Field Install Kit (TFKNI) \$185 Includes rigid ABS & adhesive	

Accessories	
Pillows from \$180	
Teak Bath Mat (TKMAT3018) \$815 <i>Custom sizes also available. Contact MTI for details and pricing.</i>	
Teak Tub Tray	
Slatted (TK-TRAY1) \$500	Solid (TK-TRAY2) \$570
Floor-Mounted High-Flow Tub Filler	
Contemporary	
Chrome (FILLC) \$1,480	
Brushed Nickel (FILLBN) \$1,710	

Drains & Overflow Kits *Must be ordered at time of purchase*

Toe Tap with Rectangular Overflow – PVC Drain Kit
Overflow is factory installed
Chrome (WOTRC) included
Brushed Nickel (WOTRBNU) substitute free of charge
White (WOTRWU) **\$55** finish upcharge

Brass Body for Rectangular Overflow with Toe Tap
(WOTRSBU) **\$480** upcharge

Slim-Line Overflow with Toe Tap Drain *Must be ordered at time of purchase*

- May upgrade rectangular overflow to Slim-Line Overflow
- Low profile overflow is factory installed
- Overflow measures 4.5" x 1"
- Provides a deeper soak
- Not available for commercial applications

Slim-Line Overflow with Toe Tap Drain
PVC Drain
Chrome (SLOTC) **\$500**
Brushed Nickel (SLOTBN) **\$530**
Polished Nickel (SLOTBN) **\$555**
White (SLOTW) **\$430**

Slim-Line Overflow with Toe Tap Drain
Solid Brass Drain
Chrome (SLOTSBC) **\$930**
Brushed Nickel (SLOTSBBN) **\$935**
Polished Nickel (SLOTSBPN) **\$935**
White (SLOTSBW) **\$965**



Rectangular overflow included



Optional Slim-Line overflow